

BACK TO BACK HANDLE INSTALLATION GUIDE PUSHKA HOME

Part A



x 2

Part B

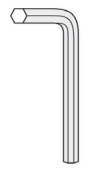

x 1

Part C



x 2

Part D



x 2

Part E



x 2

Part F



x 2

Part G

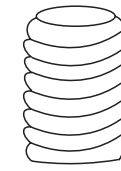

x 4

Part H

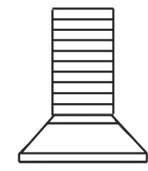

x 2

Part I

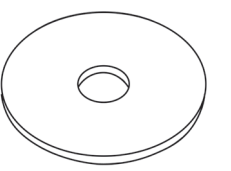

x 4

Step 1:

Drill holes into door based on the hole center of your ordered handles.

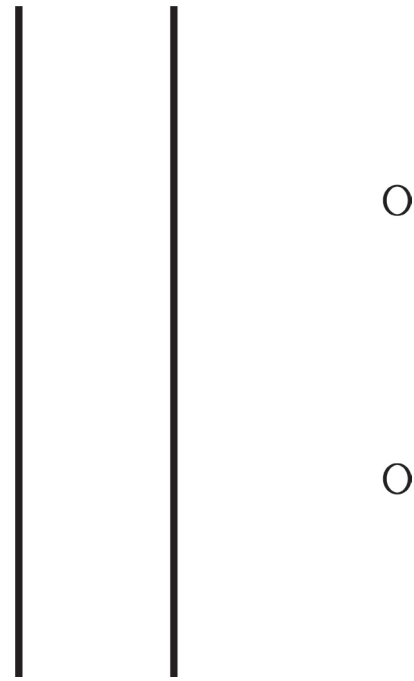

Step 2:

Required parts: A, C, E and F

Insert part F through part E into the door and then through parts C and A.

Tighten the screw (part F) to fix one side of the handle into place.

Repeat process for other leg

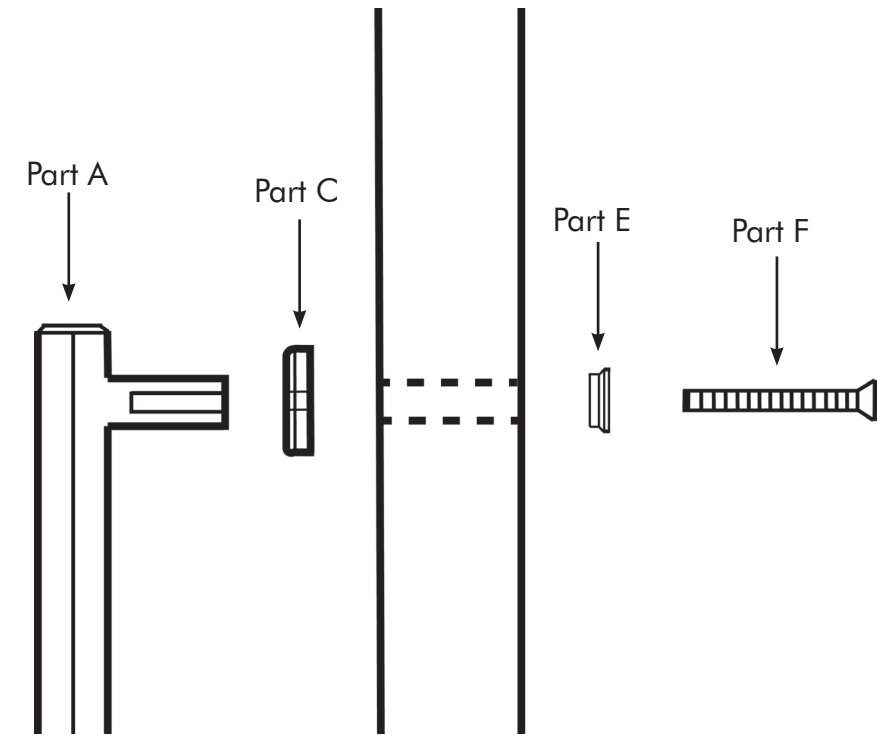

Step 3:

Required parts: D and H

Attach part D to second handle (part A) by screwing in part H.

Repeat this process on the other leg.

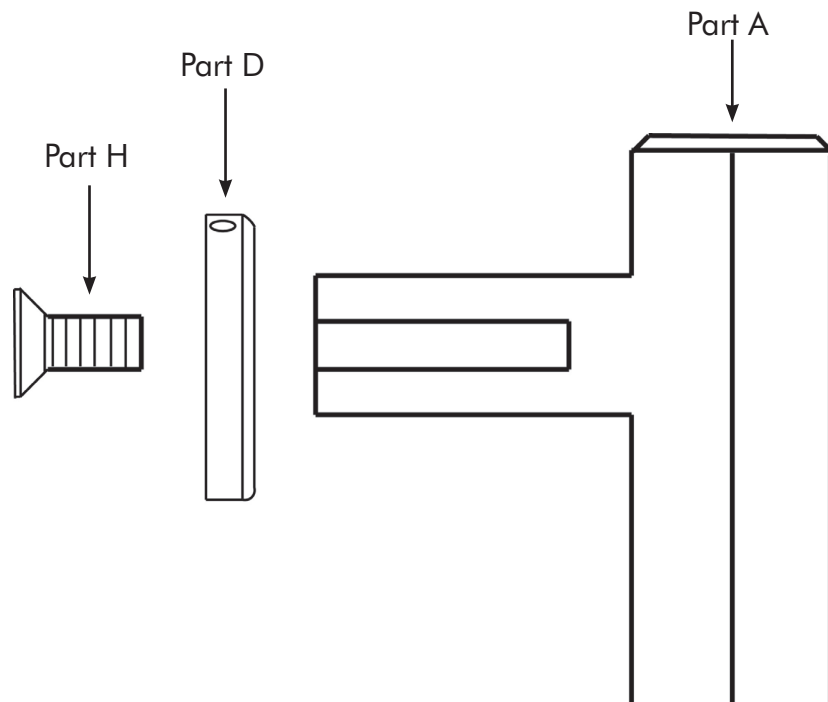

Step 4:

Required parts: D, B and G

Tighten the remaining side into place by tightening part G to D (top and bottom) by using part B.

Repeat process for other leg.

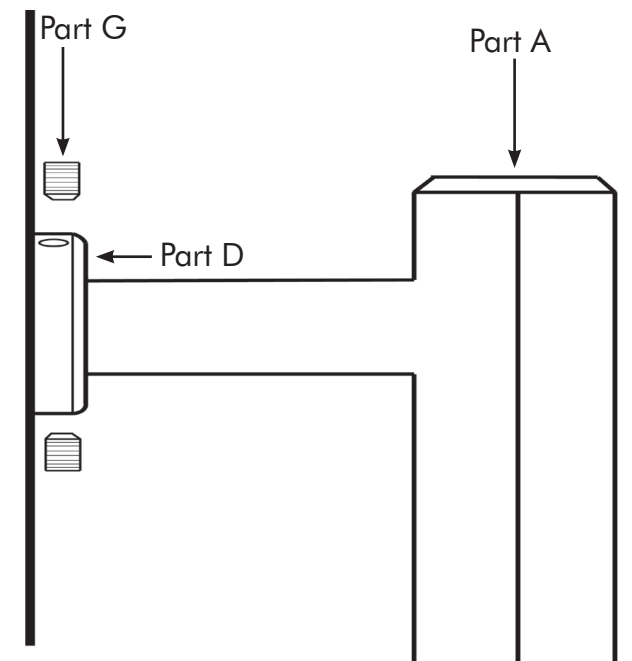

*IF APPLYING ONTO GLASS DOOR

Required Part: I

Apply part I to avoid scratching.

Repeat this process for other legs on both sides.

Do this step before step 2.

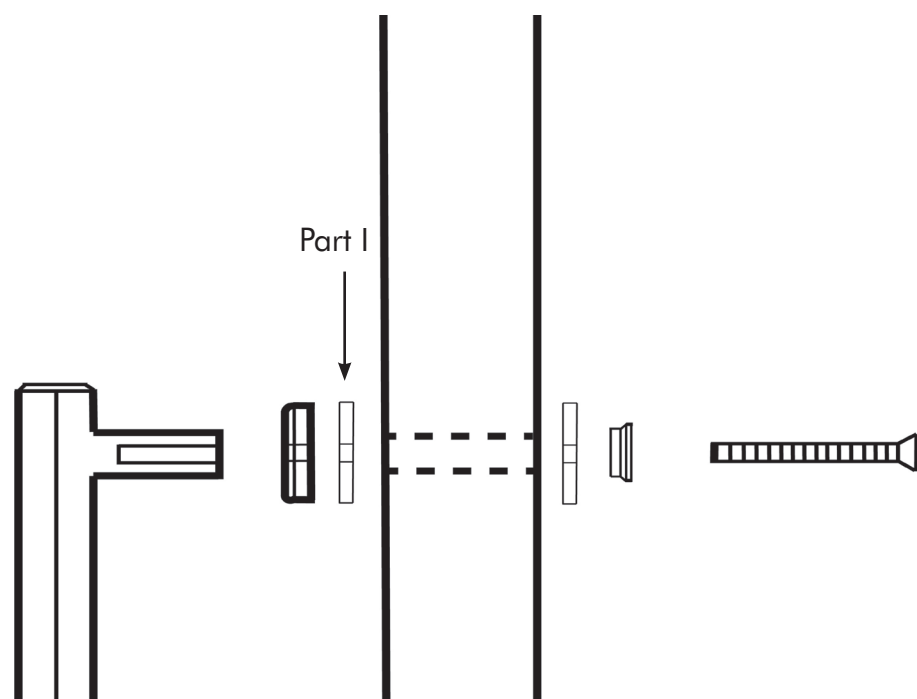

Final Look:

